

BERMAD Irrigation

BERMAD 100 Series

High Performance - Full Flow



International
Patent Pending

BERMAD 100 Series High Performance Plastic Valves

For Agriculture, Commercial Turf,
Greenhouse and Golf Course
flow-control applications



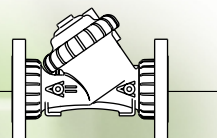

100 Series, Plastic Hydraulic Control Valves

- ▶ **Durable Industrial grade** valve design and construction uses Glass-filled Nylon material to **meet rough service conditions**.
- ▶ **Ultra-high flow capacity** with a minimal pressure loss.
- ▶ **Valve design for service on a wide range of pressure and flow conditions**, from dripping to maximum flow conditions.
- ▶ Positive guided valve plug provides **accurate motion and smooth regulation**. Avoids chattering and slamming closed.
- ▶ Simple design with few parts guarantees **easy and simple service**.
- ▶ **Versatile end connection** allows mix of different sizes and connection types. Female Threads, Flanged or PVC 'Slip-on' Glue or grooved adapter.

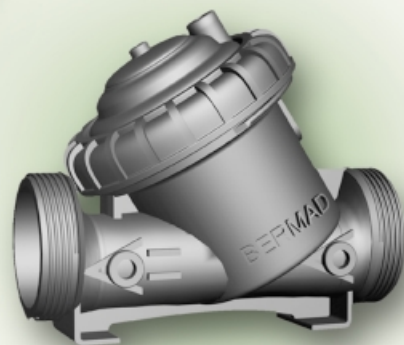
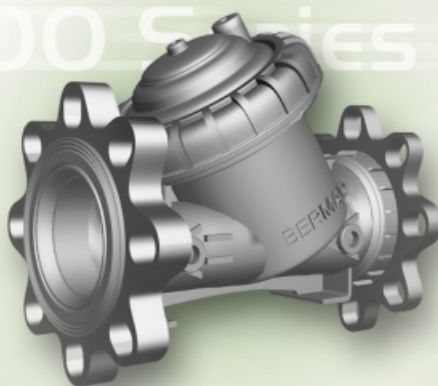
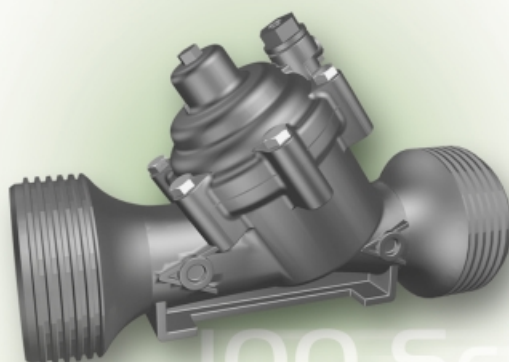
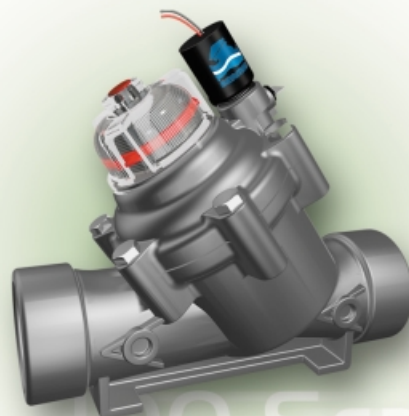

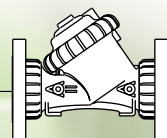

Product Description and Features

100 Series sizes:
2" ; 3" [50 ; 80]

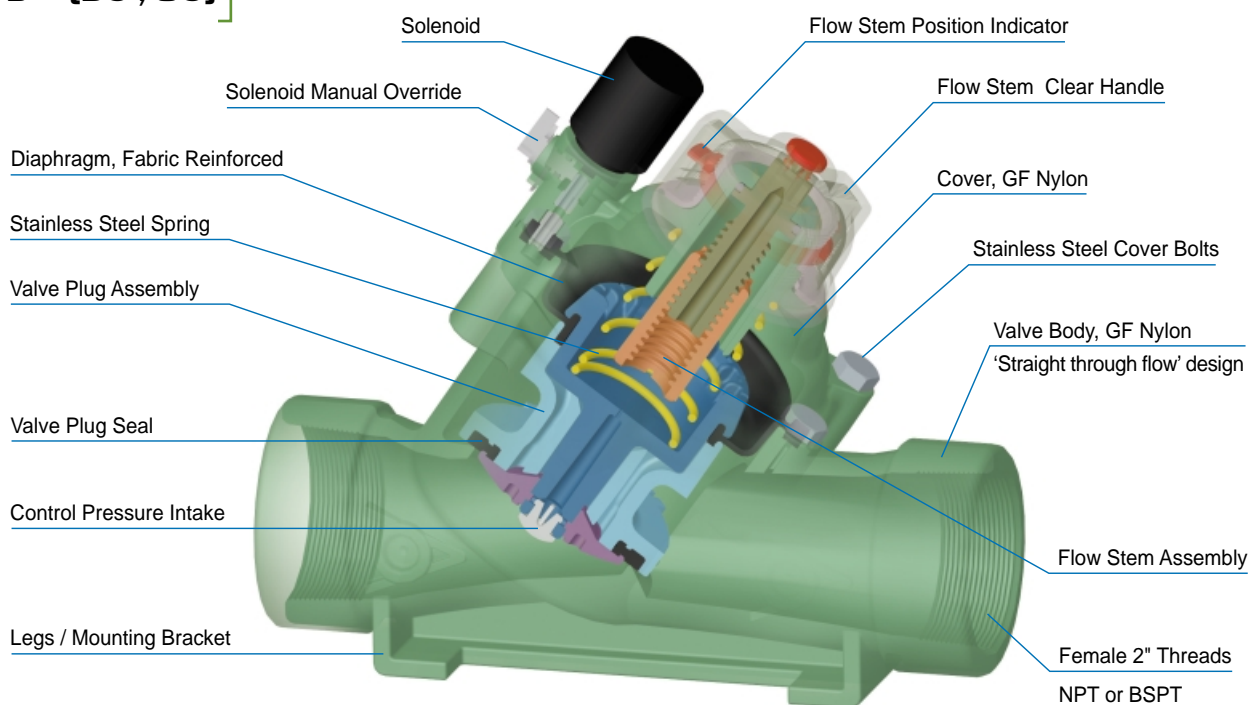

100 Series sizes:
3"L ; 4" [80L ; 100]

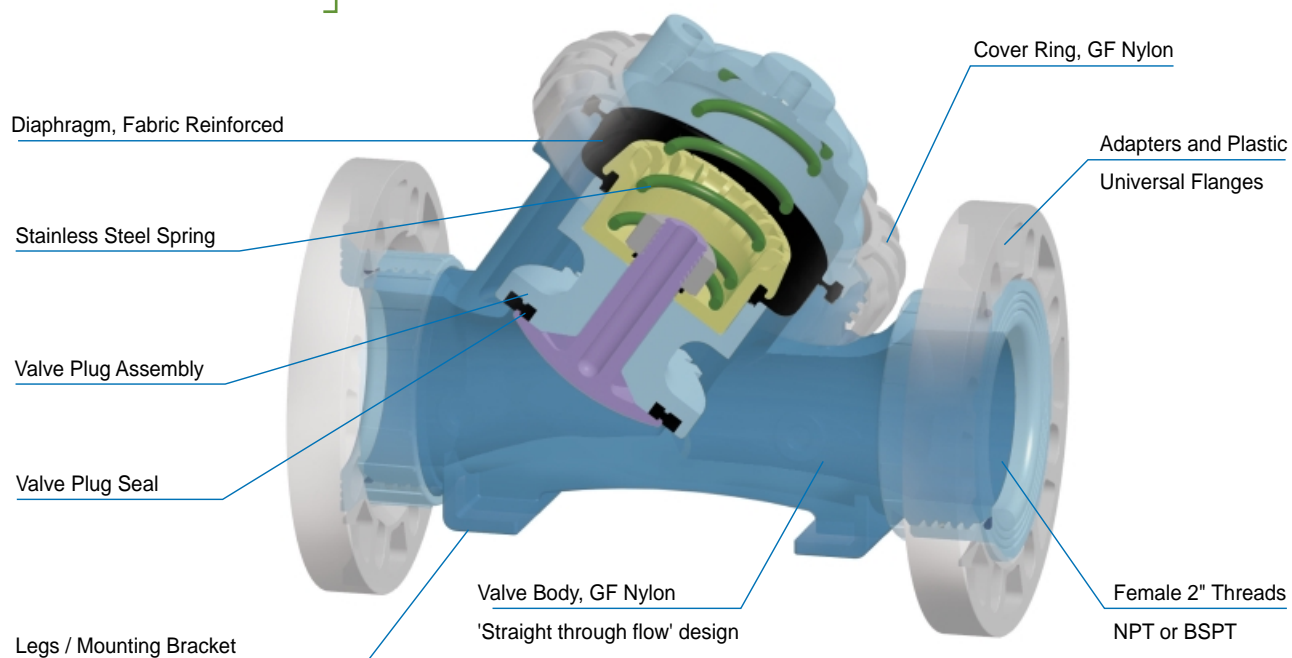

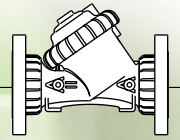

Technical information

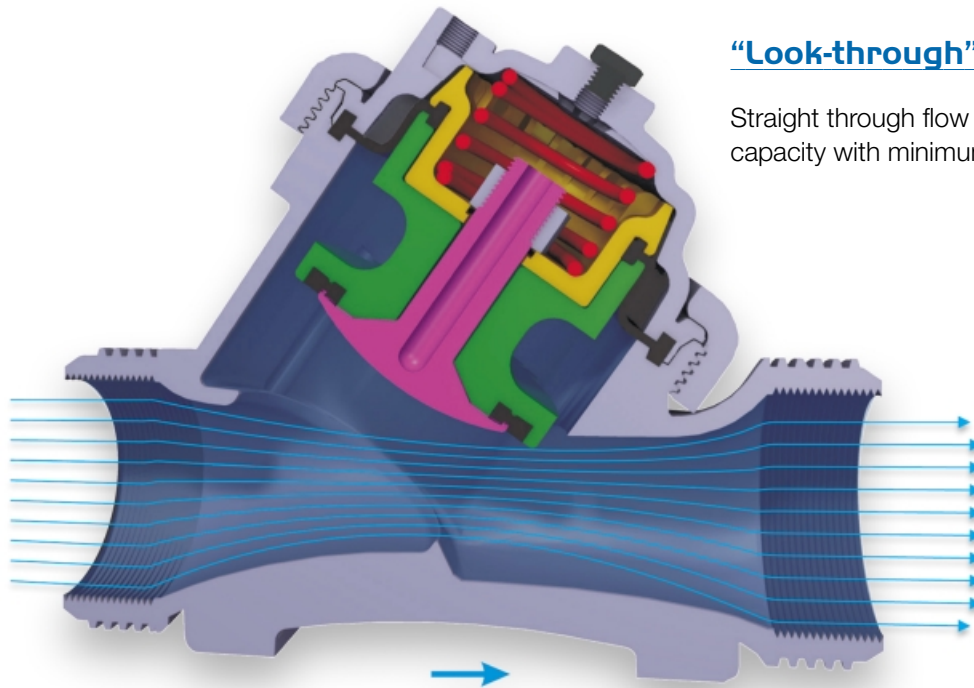

"Look-through"

Straight through flow results in ultra-high flow capacity with minimum pressure loss.

**100 Series DN, 50-80 ; 80L-100
Flow Charts (SI)**

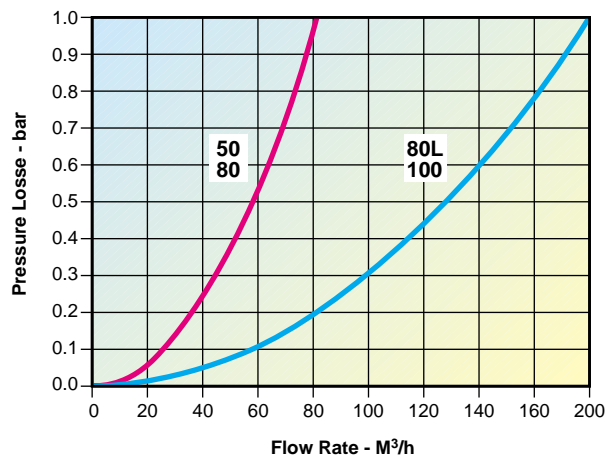

**100 Series 2"- 3" ; 3"L- 4"
Flow Charts (US)**

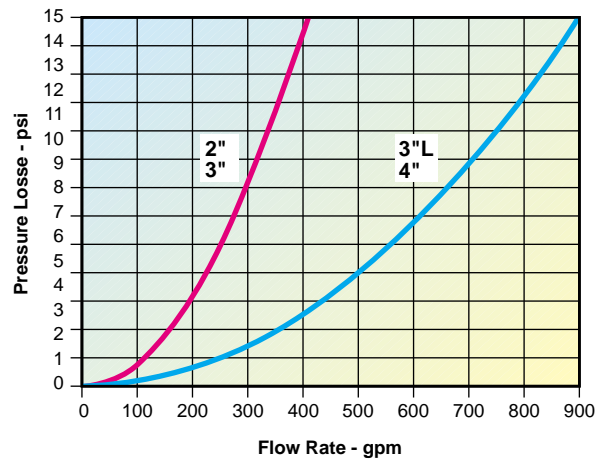

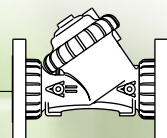

Dimensions and Weight

Size in (DN)	2" (50)		3" (80)		3" (80)		3"L (80)		3"L (80)		4" (100)	
End connections	Threaded		Threaded		Flanged		Threaded		Flanged		Flanged	
	mm	in	mm	in	mm	in	mm	in	mm	in	mm	in
Length	230	9.06	298	11.73	308	12.13	300	11.81	310	12.20	350	13.78
Height	185	7.28	195	7.68	240	9.45	240	9.45	280	11.02	290	11.42
Height (Electric)	205	8.07	215	8.46	260	10.24	-	-	-	-	-	-
h - Center to Bottom	43	1.69	53	2.09	100	3.94	53	2.09	100	3.94	110	4.33
Weight	1.3 kg	2.8 lb	1.6 kg	3.6 lb	2.6 kg	5.6 lb	2.9 kg	6.4 lb	3.8 kg	8.4 lb	4.5 kg	9.9 lb

Technical Specifications

- **Sizes:** 2", 3", 4" (DN 50, 80, 100)
- **Ends connections:** NPT ; BSPT female threads
- **Pressure ratings:** ISO PN 10 ; ANSI #125 ; JIS 10K
- **Working pressure range:** 0.5-10bar ; 7-150 psi
- **Temperature:** Water up to 80°C ; 180°F

Materials:

Body, Cover, Valve Plug – Glass Filled Nylon
Diaphragm - NBR [Buna-N], Nylon fabric reinforced
Seals, Cover bolts - Stainless Steel
Spring - Stainless steel

Tender Specifications

- The control valve have a 'Y' pattern body and be hydraulically actuated with a Semi-Roll type diaphragm.
- The 'Y' valve body will allow a significant 'Look through' from end to end.
- Valve sizes:
 2" - 3" = 90 Kv [103 Cv]
 3"L - 4" = 200 Kv [Cv 230]
- Construction material for Body Cover and Valve plug Assy, Glass Filled Nylon
- The diaphragm shall not be the sealing surface.
- The valve will have replaceable Diaphragm and Valve plug seal
- Nylon fabric reinforced Diaphragm

Optional End Connections



Threaded

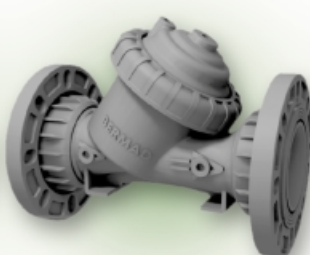

Plastic flanges

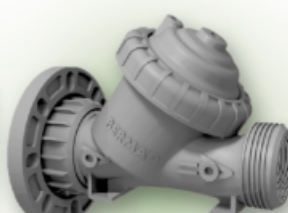

Combination end connections

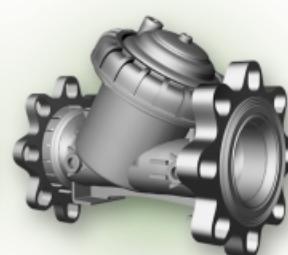

Metal "Corona" type flanges

BERMAD Irrigation

100 Series High Performance Plastic Valves

BERMAD

100 Series - High Performance Plastic Valves



BERMAD, Inc. • www.bermad.com

4070 Leaverton Court, Anaheim, CA 92807 • Phone: 800-821-6825, 714-666-1100 • Fax: 714-666 2533 • e-mail: bermad@bermadusa.com